

1×25 m

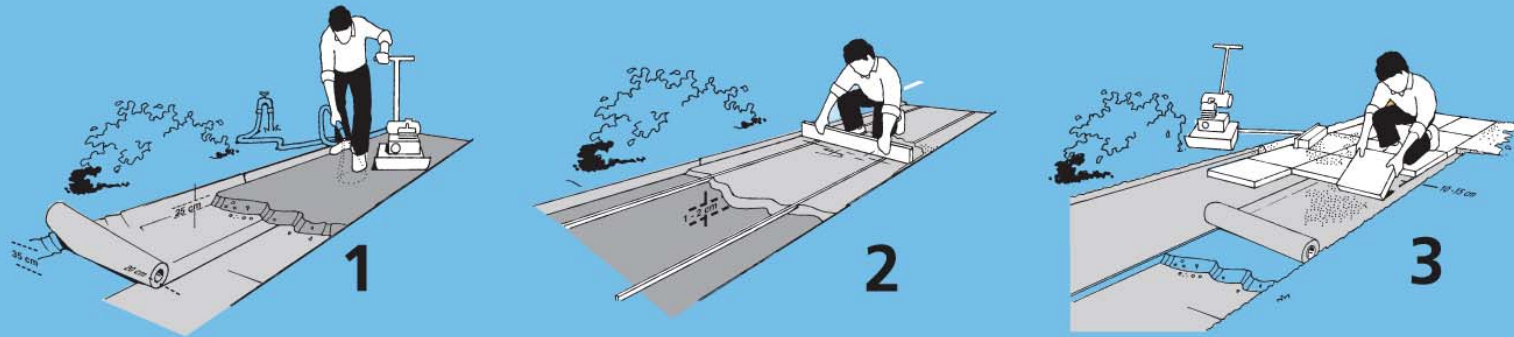

GB Patio and Walkway Stabiliser

1

- Remove about 25 cm soil and unroll the fabric overlapping the edges. Overlap lanes with 20 cm.
- Place a layer of about 10-15 cm graded aggregate.
- Hose the graded aggregate layer gently. Compact several times with e.g. a plate vibrator.

2

- Place levelling rails (for instance 3/4" water pipe) in the graded aggregate layer.
- Place 1-2 cm moist levelling layer of sand on top of the graded aggregate.
- Use a sliding bracket (a board or similar) to level the top layer.

3

- Unroll the fabric and make sure it is flush with the edge. Overlap lanes with 20 cm.
- Place the slabs 10-15 cm from the edge of the fabric.
- To prevent the slabs from sliding, fill up with soil along the edges of the slabs. (Side support is important).
- Sweep dry, fine sand between the slabs and vibrate the slab paving gently.

NB! The fabric must not be exposed for sunlight and must be covered within 8 days.